

SITE DATA TABULATION

OWNER: CRETE INVESTMENTS, LLC
PROJECT ADDRESS: 239 RALEIGH STREET
WILMINGTON, NC 28401
TAX PARCEL IDENTIFICATION #: R06400-002-008-000 (10.01 AC)
RECORDED DEED BOOK: BK 5886, PG 2491
TOTAL SITE AREA: 10.01 ACRES (436,036 SF)
CURRENT ZONING: IND - HEAVY INDUSTRIAL
CAMA LAND USE CLASSIFICATION: URBAN
MAXIMUM ALLOWABLE BUILDING HEIGHT: 35' MAXIMUM; 150' W/ ADDITIONAL SETBACKS
EXISTING LAND USE: UNDEVELOPED
PROPOSED LAND USE: CONCRETE BATCHING PLANT
SURVEY NOTES:
SURVEY BOUNDARY AND ADJACENT PARCELS PROVIDED BY BNH SURVEY COMPANY.
SURVEY DATED MAY 8, 2017.

LANDSCAPE NOTES:

- CONTRACTOR IS RESPONSIBLE FOR IDENTIFYING ALL UTILITIES PRIOR TO BEGINNING CONSTRUCTION.
- TREES SHALL BE LOCATED A MINIMUM OF 5 FEET FROM SEWER/WATER CONNECTIONS OR AS OTHERWISE DICTATED BY LOCAL REGULATIONS. CONTRACTOR SHALL BE LIABLE FOR DAMAGE TO ANY AND ALL PUBLIC OR PRIVATE UTILITIES.
- ALL PLANT MATERIAL SHALL MEET THE CURRENT VERSION OF THE AMERICAN ASSOCIATION OF NURSERYMEN'S STANDARDS.
- NO EXISTING TREES SHALL BE REMOVED WITHOUT WRITTEN AUTHORIZATION FROM THE LANDSCAPE ARCHITECT OR OWNER'S REPRESENTATIVE.
- ALL SHRUB BEDS AND/OR PLANTING AREAS EXCLUDING TURF AREAS SHALL BE MULCHED WITH 3 INCH MINIMUM AND 4 INCH MAXIMUM DEPTH PINE STRAW MULCH UNLESS OTHERWISE NOTED.
- ALL PLANTS, 4 FEET OR LESS APART, WILL BE CONNECTED IN ONE PLANTING BED. ALL GROUPS OF PLANTS SHOULD BE WITHIN ONE PLANTING BED WITH THE EDGE OF MULCH EXTENDING 2 FEET BEYOND THE EDGE OF PLANT MASS. SINGLE TREES SHOULD HAVE A CIRCLE OF MULCH NOT LESS THAN 5 FEET DIAMETER.
- PLANTING SOIL MIX: MIX EXISTING SOIL WITH THE SOIL AMENDMENTS AND FERTILIZERS IN THE QUANTITIES RECOMMENDED BY THE SOIL TESTING LABORATORY, THIRD PARTY RECOGNIZED BY THE STATE DEPARTMENT OF AGRICULTURE OR AS OTHERWISE APPROVED BY THE LANDSCAPE ARCHITECT OR OWNER'S REPRESENTATIVE.
- ANY AND ALL SUBSTITUTIONS OF PLANT MATERIAL SHALL BE APPROVED BY LANDSCAPE ARCHITECT OR OWNER'S REPRESENTATIVE. FAILURE IN OBTAINING APPROVAL MAY RESULT IN LIABILITY TO THE CONTRACTOR.
- THE CONTRACTOR SHALL REPLACE DEAD AND/OR UNHEALTHY PLANT MATERIAL WITHIN 12 MONTHS OF ACCEPTANCE OF THE INSTALLED MATERIAL FROM THE OWNER OR OWNER'S REPRESENTATIVE.
- IF IRRIGATION IS NEEDED, IT SHALL BE DESIGNED AND INSTALLED BY A LICENSED IRRIGATION CONTRACTOR IN THE STATE OF NORTH CAROLINA.
- THE CONTRACTOR IS RESPONSIBLE FOR HAND WATERING THE INSTALLED PLANT MATERIAL FOR A PERIOD OF 6 MONTHS FROM THE ACCEPTANCE FROM THE OWNER OR OWNER'S REPRESENTATIVE IF IRRIGATION HAS NOT BEEN INSTALLED. ALL MATERIAL INCLUDING SOD AND SEEDED AREAS SHALL BE HAND WATERED ONCE WEEKLY OR AS NEEDED TO ENSURE SURVIVAL OF PLANTS.
- CONTRACTOR IS RESPONSIBLE FOR REMOVING TRASH, DEBRIS AND EXCESS MATERIALS FROM THE JOB SITE ONCE THE PROJECT IS COMPLETE. SECURING ANY MATERIALS LEFT ON SITE DURING THE COURSE OF THE PROJECT IS THE CONTRACTOR'S RESPONSIBILITY.
- ALL DISTURBED AREAS SHALL BE SEEDED.
- PRIOR TO ANY CLEARING, GRADING OR CONSTRUCTION ACTIVITY, TREE PROTECTION FENCING WILL BE INSTALLED AROUND PROTECTED TREES OR GROVES OF TREES.
- NO CONSTRUCTION WORKERS, TOOLS, MATERIALS OR VEHICLES ARE PERMITTED WITHIN THE TREE PROTECTION FENCING.

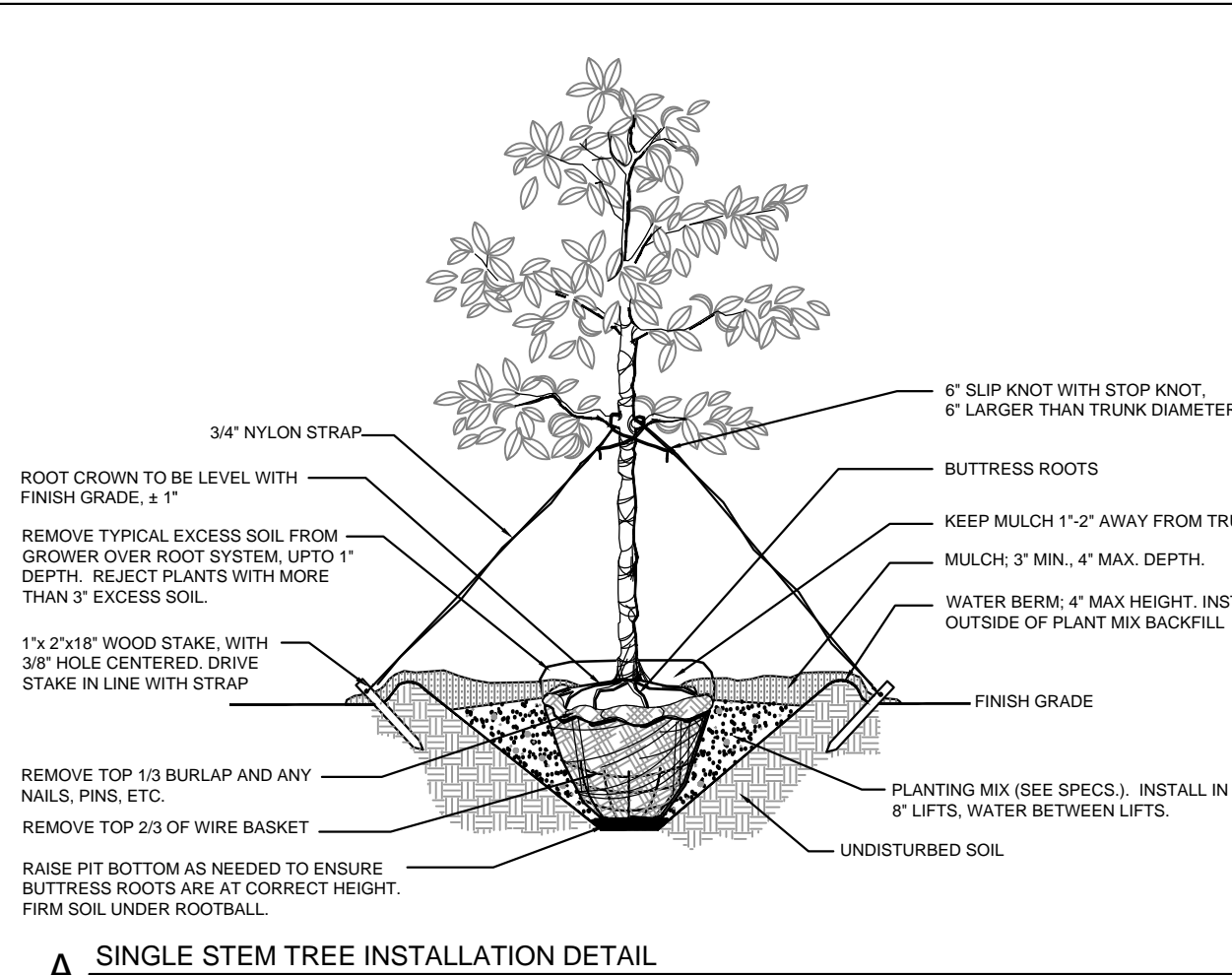

A SINGLE STEM TREE INSTALLATION DETAIL

LANDSCAPE CALCULATIONS:

RALEIGH STREET PRIMARY STREETYARD (MAX WIDTH 37.5', MIN WIDTH 12.5') (529.68 LF - 60 LF OF DRIVEWAYS) = 469.68 LF * 25 1 CANOPY / 600 SF (19.57 MULTIPLIER) 6 SHRUBS / 600 SF	REQUIRED 11,742 SF 20 118	PROVIDED 11,742 SF 20 118
PARKING AREA INTERIOR 5,815 SF * 20% SHADING LARGE SHADE / CANOPY TREES @ 707 SF	1,163 SF 2	2,828 SF 4
PARKING AREA PERIMETER - N/A		
FOUNDATION PLANTINGS PHASE 2 OFFICE BUILDING 40 LF * 20 FT HGT * 0.12	96 SF	144 SF
BUFFERYARDS - N/A		
TREE REMOVAL & MITIGATION - SEE CHART AND NOTES THIS SHEET.		

Raleigh St. Tract - City of Wilmington Tree Removal within Areas of Essential Site Improvements					
Quantity of Trees	Caliper Inches/ Tree	Tree Common Name	Tree Type	Tree Location	Total Cal. Inches
Regulated Trees					
Category I Mitigation (100%)					
11	12	Oak	hardwood	Pond/Agregate Loading	132
1	14	Oak	hardwood	Pond/Agregate Loading/Recycle	14
Category III Mitigation (50%)					
1	18	Loblolly Pine	conifer	Pond/Agregate Loading	18
Total Regulated Tree Caliper Inches to be Removed on Site for Essential Site Improvements					164
Total Regulated Tree Caliper Inches to be Mitigated on Site					0

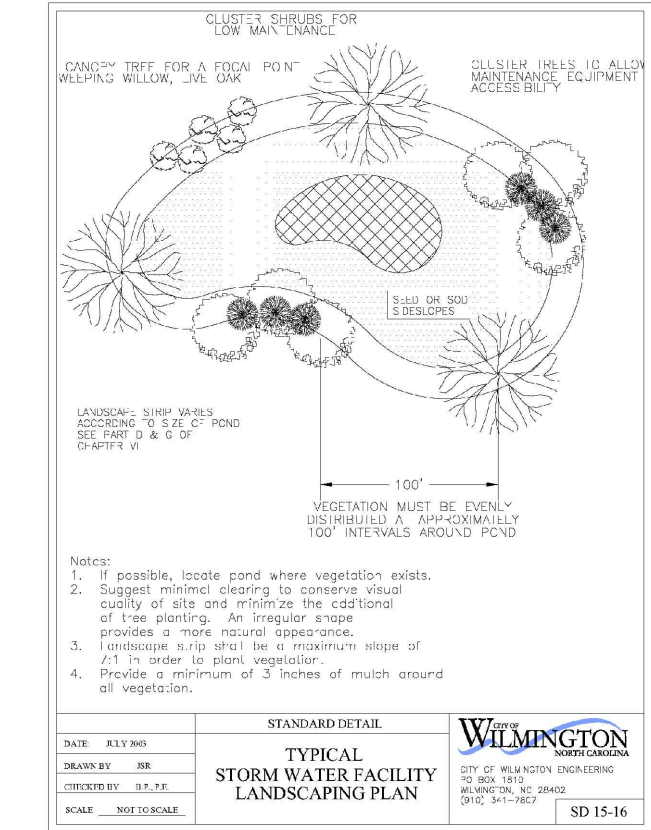

10' REQUIRED LANDSCAPE BUFFER IS AREA FROM TOP OF BANK OUTWARD; SEE POND DETAIL FOR WETLAND SHELF PLANTINGS.

PLANT SCHEDULE			
TREES	QTY	COMMON NAME	SIZE
AMH	17	AMERICAN HOLLY ILEX OPACA	2.5" CAL
BCY	4	BALD CYPRESS TAXODIUM DISTICHUM	2.5" CAL
BOE	3	BOSQUE ELM ULMUS PARVIFOLIA 'BOSQUE'	2.5" CAL
SHRUBS	QTY	COMMON NAME	CONT
LORR	8	RUBY LOROPETALUM LOROPETALUM CHINENSE 'RUBY'	7 GAL
VPIT	119	VARIEGATED MOCK ORANGE PITTOSPORUM TOBIRA 'VARIEGATA' 12' HGT. MIN.	7 GAL
WM	7	WAX MYRTLE MYRTICA CERIFERA	4' HT

30
NOW OR FORMERLY
ECKS AND DOCKS LUMBER CO., INC.
MB. 38, PG. 340,
DB. 5286, PG. 2581
R06500-002-001-0000
730 - BUSINESS
ZONED: IND - HEAVY INDUSTRIAL

31
NOW OR FORMERLY
SEAHAWK LANDING, LLC
MB. 35, PG. 108,
DB. 5910, PG. 1141
R06500-002-044-0000
899 - OTHER SERVICES
ZONED: IND - HEAVY INDUSTRIAL

TREE TO REMAIN, TYP.
TREE TO BE REMOVED, TYP.

PROPOSED DUMPSTER ENCLOSURE. SEE DETAIL
PROPOSED MODULAR OFFICE FOR PHASE 1; PARKING FOR PHASE 1 & 2 TO BE CONSTRUCTED IN PHASE 1; OFFICE TO BE REMOVED AFTER PH 2 OFFICE CONSTRUCTED

PROPOSED TREE LINE, TYP.

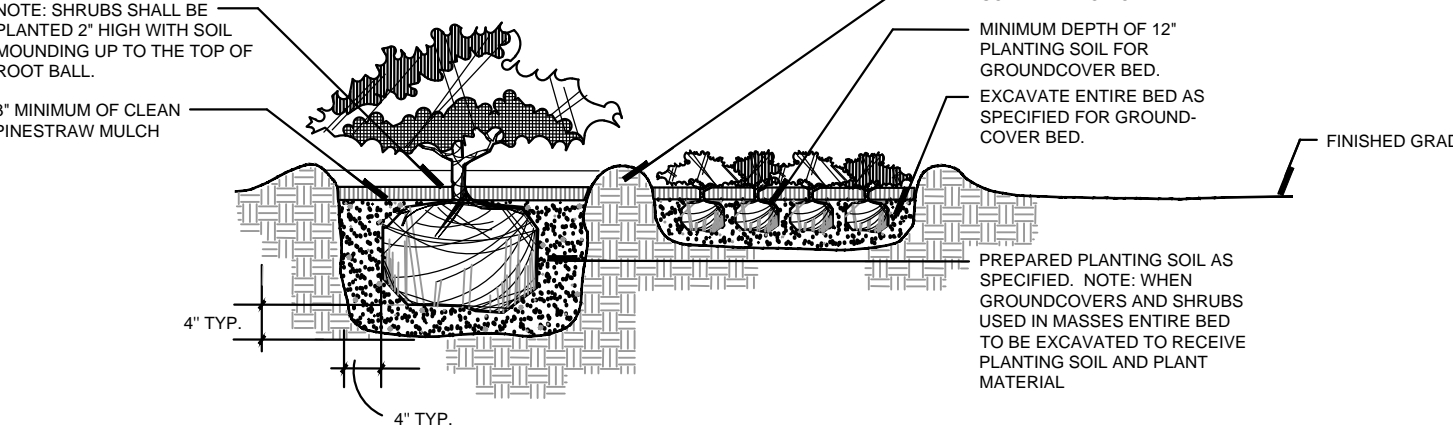
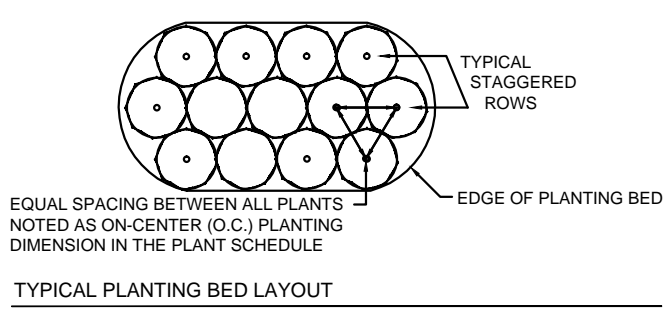

B SHRUB INSTALLATION DETAIL

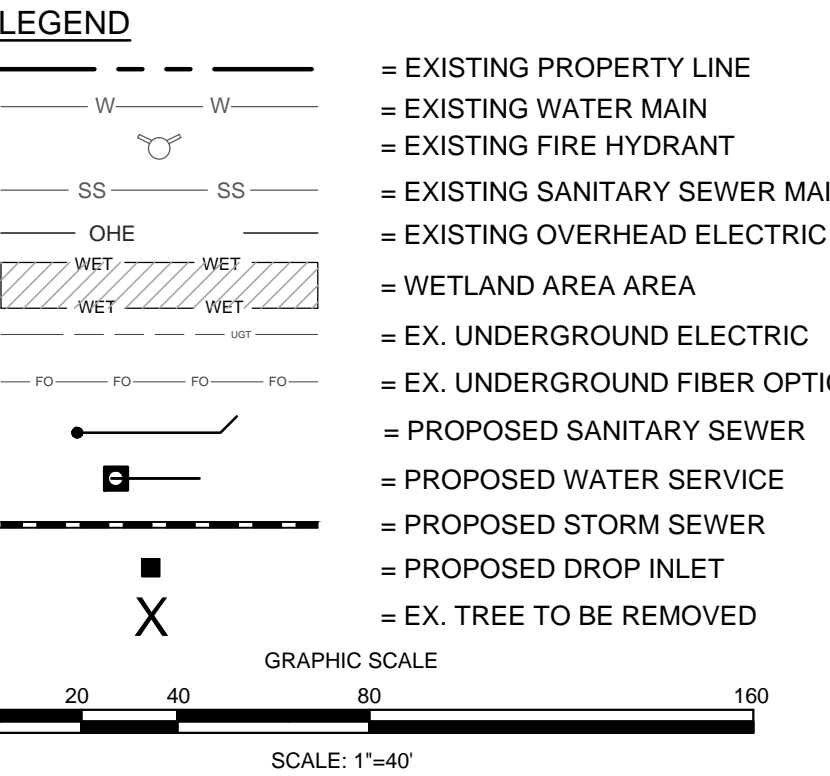

WILMINGTON
NORTH CAROLINA
Public Services • Engineering Division
APPROVED STORMWATER MANAGEMENT PLAN
Date: Permit #
Signed: _____
Approved Construction Plan
Name Date
Planning _____
Traffic _____
Fire _____

NC DENR PWSS WATER PERMIT #:
WATER CAPACITY: GPD
DWQ SEWER PERMIT #:
SEWER CAPACITY: GPD
SEWER SHED # AND PLANT:
SEWER TO FLOW THROUGH NEI: YES or NO (CIRCLE ONE)
For each open utility cut of City streets, a \$325 permit shall be required from the City prior to occupancy and/or project acceptance.



Know what's below.
Call before you dig.

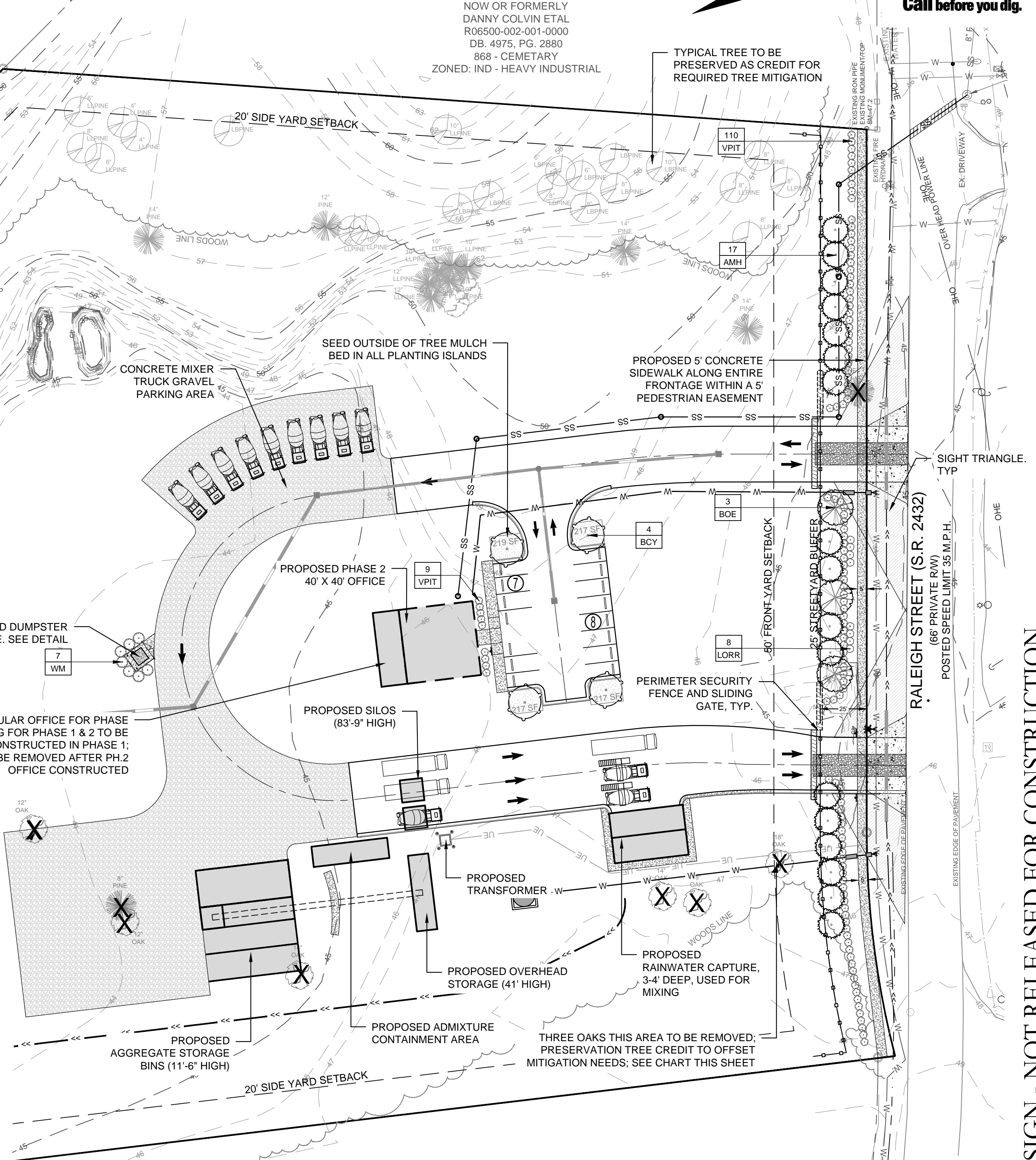

Raleigh St. Tract - City of Wilmington Tree Mitigation for Regulated Trees								
Quantity of Trees	Caliper Inches/ Tree	Tree Common Name	Tree Type	Tree Location	Total Cal. Inches	CoW Mitigation %	Total 2.5" - 3" Replacement Trees	Tree Preservation Credit
Regulated Trees								
Category I Mitigation (100%)								
2	18	Oak	hardwood	Recycled Aggregate Area	36	100		12
1	14	Oak	hardwood	Recycled Aggregate Area	14	100		5
Total Regulated Tree Caliper Inches to be Removed on Site for Essential Site Improvements					50			
Total Regulated Tree Caliper Inches to be Mitigated on Site								17
Total Preserved Trees to offset Required Mitigation								22 Loblolly and Loblolly Pines greater than 2" cal.

PRELIMINARY DESIGN - NOT RELEASED FOR CONSTRUCTION

REVISIONS:
REV 1: REVISED PER TRC COMMENTS
REV 2: REVISED PER TRC COMMENTS
8/18/17
10/23/17

CLIENT INFORMATION:
CRETE INVESTMENTS
2005 Eastwood Road, Suite 200
Wilmington, NC 28403

PARAMOUNT ENGINEERING, INC.
122 Cinema Drive
Wilmington, North Carolina 28403
(910) 791-6707 (O) (910) 791-6760 (F)
NC License #: C-2846

LANDSCAPE PLAN
239 RALEIGH STREET
WILMINGTON
NEW HANOVER COUNTY, NC

PROJECT STATUS:
CONCEPTUAL LAYOUT:
FINAL DESIGN:
RELEASED FOR CONSTRUCTION:
DRAWING INFORMATION:
DATE: 08/11/17
SCALE: 1" = 40'
DRAWN BY: AHE
CHECKED: RPB

SEAL
NORTH CAROLINA
1823
10/23/17
ALEXANDER H. ENGELBRECHT
REGISTERED PROFESSIONAL ENGINEER

L-1.0
PEI JOB#: 17256.PE